

4. Remove one screw (1) and remove the solenoid (2).

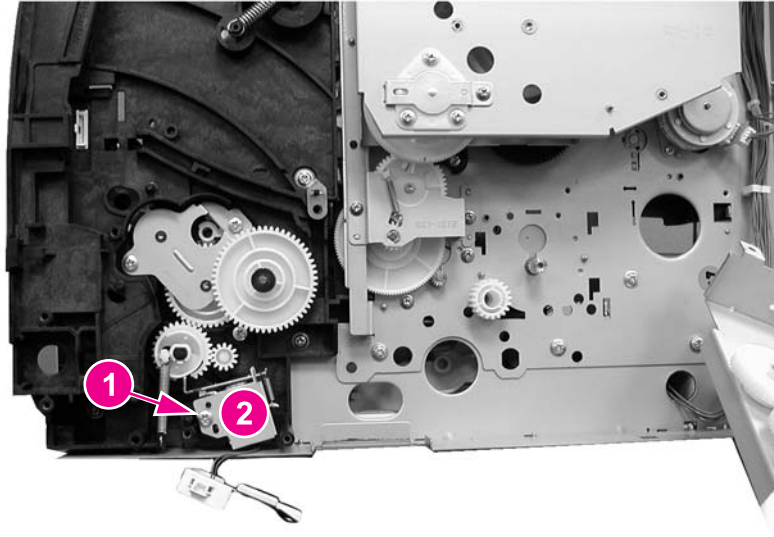

Figure 6-91. Tray 2 pick-up solenoid removal (2 of 2)

Secondary transfer roller engaging solenoid (SL4) removal

1. Remove the pick-up/feed assembly. See [Pick-up/feed assembly removal](#).
2. Remove five screws (1), the gear side plate (2), plate (3), solenoid (4), and the connector cover (5).

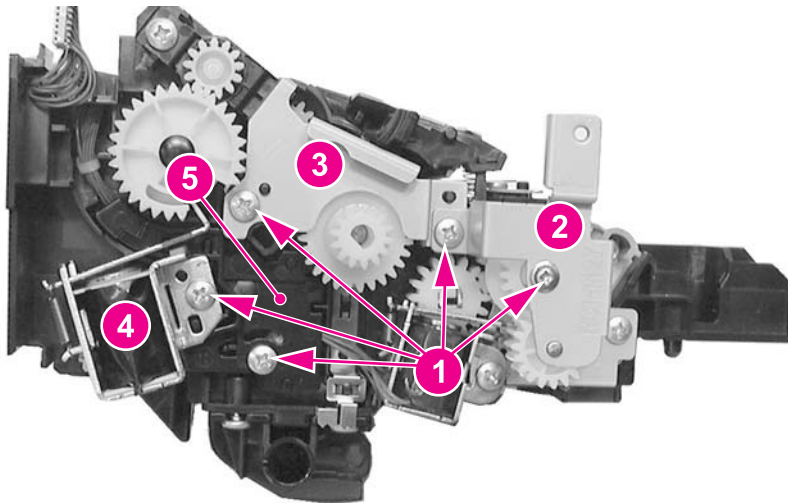

Figure 6-92. Secondary transfer roller engaging solenoid removal (1 of 2)